

MICROFLEX DIRECT FLOW FILTER

Models

- MicroFlex 12

- MicroFlex 24

- MicroFlex 48

Technical description

The MicroFlex filtration plant operates on a linear and gentle flow process that utilizes standard membrane Code 7 cartridge filters. Incorporating high automation programming called IntelliFlex, the MicroFlex filter manages the entire filtration process and provides you with bottle ready wine in a single pass.

The MicroFlex series of filters comes in 3 sizes, the 12, 24 and 48 model. The model number indicates the installed number of filter cartridges. The MicroFlex 12 has fully automated filtration cycles but requires the operator for the washing cycle, whereas the MicroFlex 24 and 48 models are completely automated.

The MicroFlex filtration plant has been designed to treat both red and white wines, either still or sparkling.

The MicroFlex filtration system offers the following advantages:

- Well designed and dependable automation
- Excellent plant cleanliness, easy to clean
- Excellent product quality and very gentle process
- Interchangeable membranes, allowing different levels of filtration
- Suitable for all winery filtrations
- Extremely low energy consumption
- No product warming

Automation

The MicroFlex 12 model is equipped with manual valves but no washing tank and detergent dosing pumps. A PLC automatically manages the whole filtration cycle but an operator must be present to manually operate the valves for both intermediate and final washing cycles.

The MicroFlex 24 and MicroFlx 48 models are equipped with automatic, pneumatically operated valves, and includes installed washing tank and detergent dosing pumps. These models are able to automatically complete every phase: filling, filtration, emptying, washing, etc. without any operator's help and is fully programmable at every level of operation.

All phases of operation including start-up and shut-down set points, thresholds, and times of valves and pumps are set by a Touch Screen control panel displaying all information on the plant. The operation of the pumps and the automatic valves during the production and washing phases are driven and controlled by the PLC. The operating parameters and alarms are controlled by the PLC which will prevent the plant from operating during any irregular condition or during any possible unsafe condition for the operator(s) or the membrane cartridges.

OPTIONS	MICROFLEX 12	MICROFLEX 24	MICROFLEX 48
Radiocontrol for the remote control of the start and stop of the MicroFlex filter	•	•	•

• available

TECHNICAL DATA	MICROFLEX 12	MICROFLEX 24	MICROFLEX 48
Number of module (n.)	12	24	48
Filtered product delivery (aprx) (m3/h)	1,2-6,0	2,4-12,0	4,8-24,0
Working temperature (°C)	20	20	20
Installed electric power (kW)	2	5,5	7,4
Empty weight (Kg)	300	680	970
Voltage (P/V/Hz)	3x380/50	3x380/50	3x380/50
Compressed air (bar)	10	10	10

N.B. The above data is indicative and not binding.

Drawing MicroFlex 12

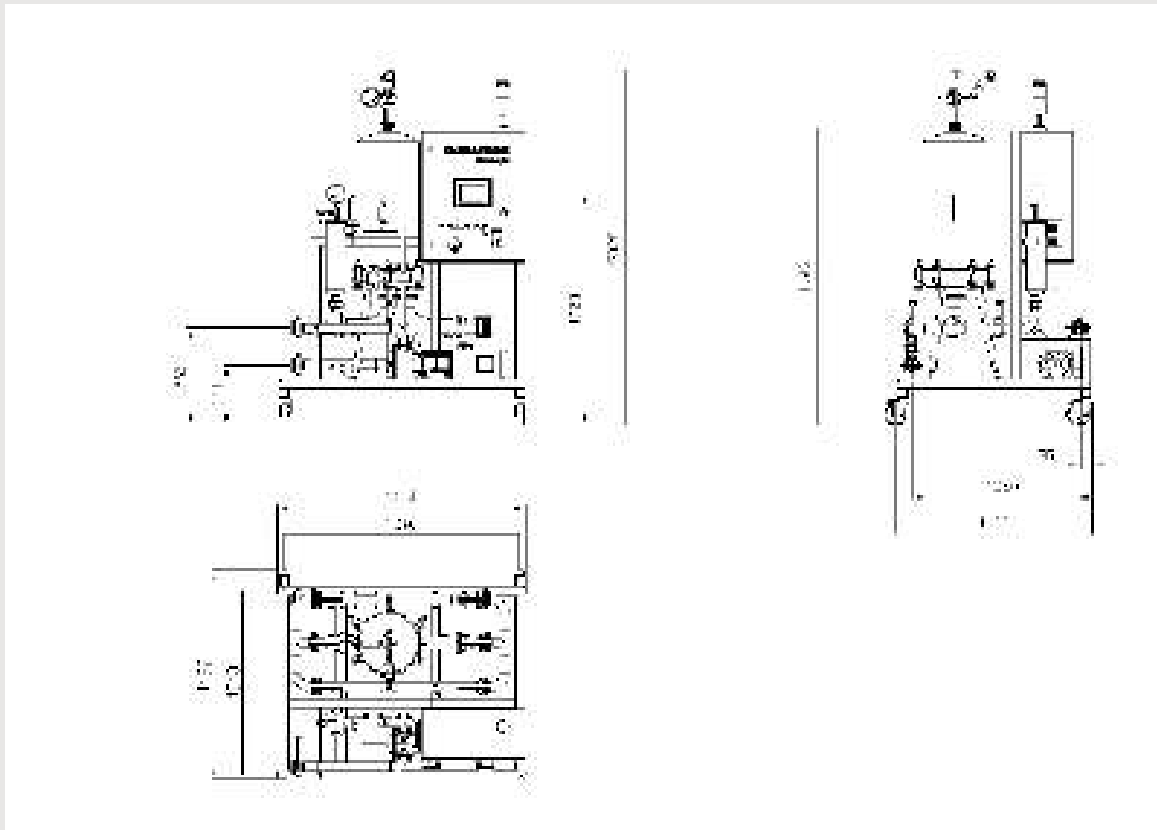

Drawing MicroFlex 48

